



NEW ENGLAND CLASSIC® - WALL PANEL SYSTEMS

PANEL TERMINOLOGY

The New England Classic® Panel System includes all components needed for installation.

Installer provides fasteners and finishing.

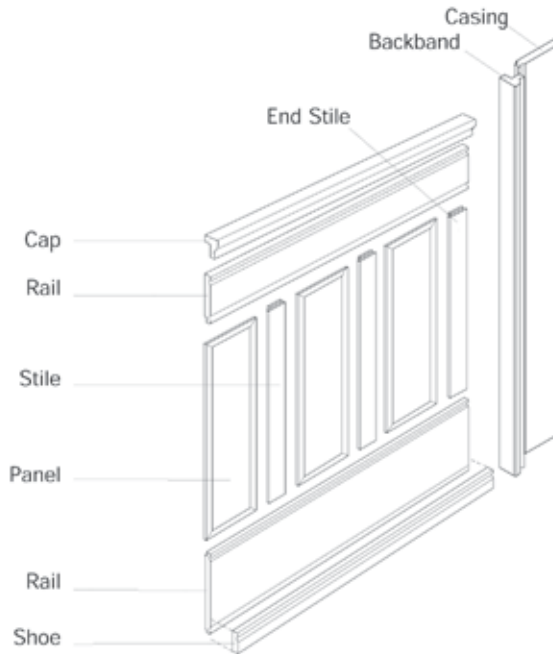

Components are packaged for convenient ordering, handling and use.

PanelSet® Available in 9", 12", 18" and 23" panel widths.
Each package contains:
• 4 panels (6" wide, no stiles)
• 4 stiles (3" wide)

FramePak® Available in 32" and 36" heights x 8' long.
Each package contains:
• 1 cap
• 1 top rail
• 1 rail
• 1 shoe

StilePak® Adjusts layout to fit variable length walls, completes corners and windows by trimming to desired width.
Each package contains:

6" PanelSet® Adjusts the layout to fit variable length walls.
Each package contains:
• 4 end stiles (10" wide)

CasingPak® Window and door trim designed to match.
Each package contains: (8' long)
• 3 backbands
• 3 casings

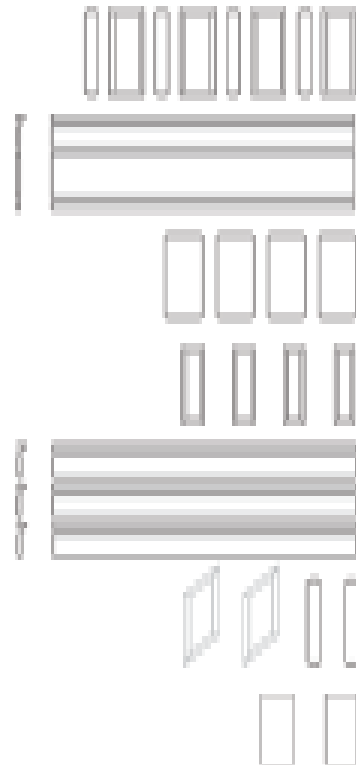



NEW ENGLAND CLASSIC® - WALL PANEL SYSTEMS

PROJECT DESIGN REQUEST

1. Measure your room (to the nearest 1/4") , include:

- Wall lengths
- Door locations (from corners of room)
- Door casing width
- Window location (from corners of room to inside edge of window frame)
- Window sill height (floor to bottom of sill)
- Window height (inside edge top frame to inside edge bottom frame)
- Window casing width
- Window casing to frame reveal

2. Fill out the door and window chart on Page 2

(see example at right) include :

- Door height and width; casing width
- Window width and height; height to bottom of sill; casing width and reveal

Windows and Doors

Item	Door or Window	Size		Window Sill	Casing	
		Width	Height	Height	Width	Reveal
1	W	36"	60"	25"	3"	1/4"
2	W	36"	60"	25"	3"	1/4"
3	D	36"	80"	n/a	3"	1/4"
4						
5						
6						
7						
8						
9						
10						

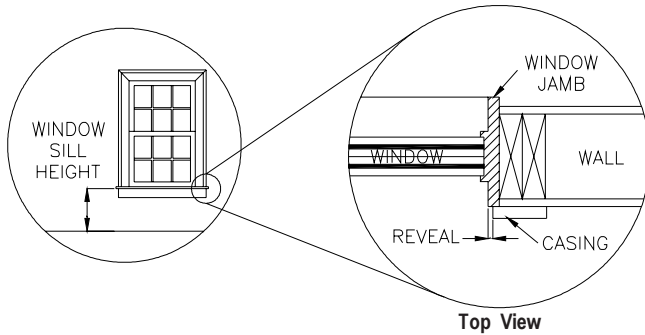

Note: Reveal equals distance between inside edge of frame and inside edge of casing.

3. Sketch your project onto the grid shown on page 2 of the Project Design Request using the dimensions from Step 1. See example of sketch to the right, be sure to show:

- Wall lengths
- Door and window locations and corresponding item number from Step 2

4. FAX your complete dimensions and sketch to your MARTIN-NAMCO sales rep / office.

5. Receive your custom design and material in a timely manner.

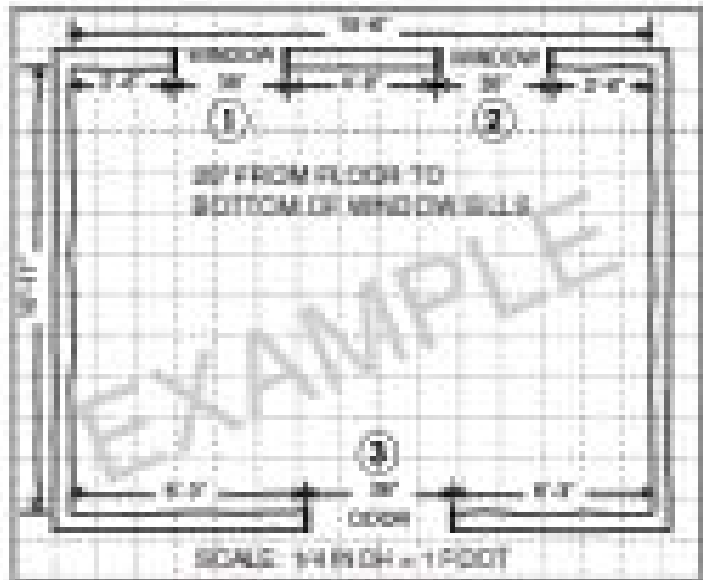



NEW ENGLAND CLASSIC® - WALL PANEL SYSTEMS
PROJECT DESIGN REQUEST - page 2



1. Print your name, address, daytime phone number and fax number. Fax to your MARTIN-NAMCO sales rep / office.

Name _____
Address _____
City State Zip _____
Daytime phone (____) _____
Fax (____) _____

Windows and Doors

Item	Door or Window	Size		Window Sill	Casing	
		Width	Height	Height	Width	Reveal
1	W D					
2	W D					
3	W D					
4	W D					
5	W D					
6	W D					
7	W D					
8	W D					
9	W D					
10	W D					

2. Check your design preference below that will create the style you are looking for .

A. Classic Traditional or Classic American

Panel width: 9" 12" 18" 23" 31"

Height: 32" 36" Other

or B. 8" BeadBoard

Height: 32" 36" 40" 44" 69"

C. Project Type: New Remodel

D. Casing Pak: Yes No

E. Species Paint Oak Maple Cherry

Factory-Finished Primed Natural Medium Cherry

DRAW ROOM BELOW (use additional sheets if needed)



NEW ENGLAND CLASSIC® - WALL PANEL SYSTEMS

STAIR PANEL SYSTEM DESIGN SERVICE

Guidelines for measuring stairs:

- Measure the stairs using the guidelines below and fill out the table.
Note: Please include plan dimensions of any landings connected to stairs.
- Fax the completed form to your **MARTIN-NAMCO sales rep / office**.

You should have your Free Design and suggested material list within two business days.

<p>Step 1: Looking upward from the bottom of the stair, determine if the panels will go on the right or left side.</p> <p>Step 2: Measure tread width to the nearest 1/8".</p> <p>Step 3: Measure riser height to the nearest 1/8".</p> <p>Step 4: Measure overhang/nosing to the nearest 1/8".</p> <p>Step 5: Measure the diagonal length of the finish stringer in inches.</p> <p>Step 6: Measure the height of finish stringer (top and bottom).</p> <p>Step 7: Please include the number of risers in the stairs.</p> <p>Note: Please measure more than 3 steps and choose the most common measurement for the chart (steps 2, 3, and 4).</p>	1. Stair type (circle)		R or L	
	2. Tread width			
	3. Riser height			
	4. Overhang / nosing			
	5. Diagonal length of stringer			
	6. Height of finish stringer		top	bottom
	7. Number of risers			

UPPER STAIR MEASUREMENTS

LOWER STAIR MEASUREMENTS

